

Samsung® Jack™ Version



Duet™ ²⁻ⁱⁿ⁻¹ MONITOR

Wireless Event and MCT in One

Quick Start Patient Guide

What you need to get started:

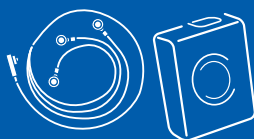

1. Pendant with patient cable



2. Smartphone



3. Skin prep pad

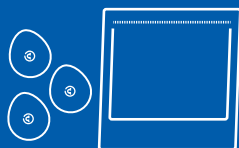

4. Packet of electrode patches



5. "AA" Alkaline Battery



6. Pendant belt clip

This guide will walk you through the basics of starting and using your Medicomp cardiac monitor for your heart monitoring procedure, as prescribed by your physician.

To provide your doctor with the best data to evaluate your cardiac health, it is important that you use the monitor properly and for the prescribed length of time.

Online Patient Center

medicompinc.com/patient-center

- Videos and How-To Guides
- Frequently Asked Questions
- Order Replacement Supplies

Telephone Assistance: 877-996-5553



Monitor Diagram

Pendant

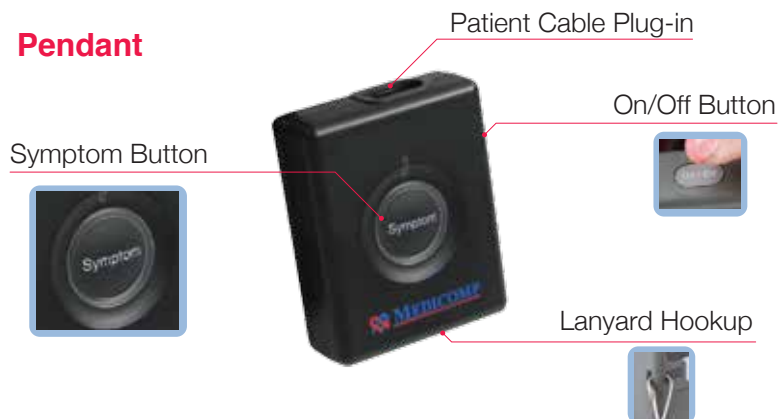

Smartphone



The locations of Smartphone controls may vary depending on the model you receive.

Charging the Smartphone

The Smartphone needs to be charged daily. Plug the charger into the Smartphone and into a wall outlet. A red indicator light should show on the top of the Smartphone while charging.

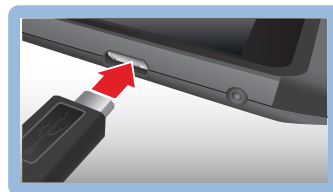

tip If at anytime during your procedure you believe you are having a medical emergency, call 911. Continue to wear the monitor until advised by a medical professional.

QSG0000560-02B

Recording and Sending Symptoms

When you experience a symptom, or at other times as directed by your doctor, press the **Symptom** button to record your heart's activity.

The Smartphone will display *Recording in Progress*. If the screen has gone dark to conserve power, press any key to light it up.

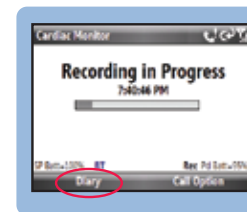
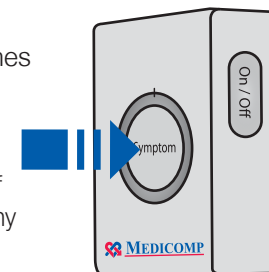

Press the **Left Soft Key** under *Select Options*.

Press the **Select** key to display a list of symptoms from which to choose.

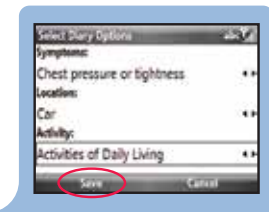

While *Recording in Progress* is displayed on the Smartphone, press the **Left Soft Key** under *Diary*.

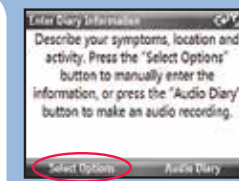

Use the **Up Arrow** and **Down Arrow** keys to move through the list. Press the **Select** key when the desired symptom is highlighted.

When finished, press the **Left Soft Key** under *Save*. The *Recording* or *Monitoring* display will return.

Diary Entries: It is important for your doctor to know the symptom you felt, your location and what activity you were doing each time you make a manual recording.

tip You may use the built-in Audio Diary to make a voice recording as your diary entry. Just press the Right Soft Key under *Audio Diary* and follow the instructions.

Returning the Equipment

When your procedure is complete, place the Smartphone, Pendant, Pendant Batteries, Battery Charger and Charger Cord – along with any unopened Electrode Patches and other unused accessories – back into the Kit. Place the kit into the postage pre-paid return envelope included in the kit, seal it, and then place the package into your mailbox or any USPS mailbox to be delivered back to Medicomp.

Property of Medicomp

All equipment is property of Medicomp. Please return promptly after use. Unreturned items may be invoiced.

1 Preparing Your Skin

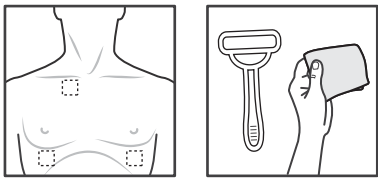

Take care in preparing your skin for application of the adhesive skin patches (electrodes). Good skin preparation means better ECG signal traces that, in turn, are easier for the doctor to review and evaluate.

Find locations Shave/Prep

Using the illustration below as a guide, choose areas of the chest that are flat and not very muscular. Avoid skin folds or creases, irritated skin and scars.

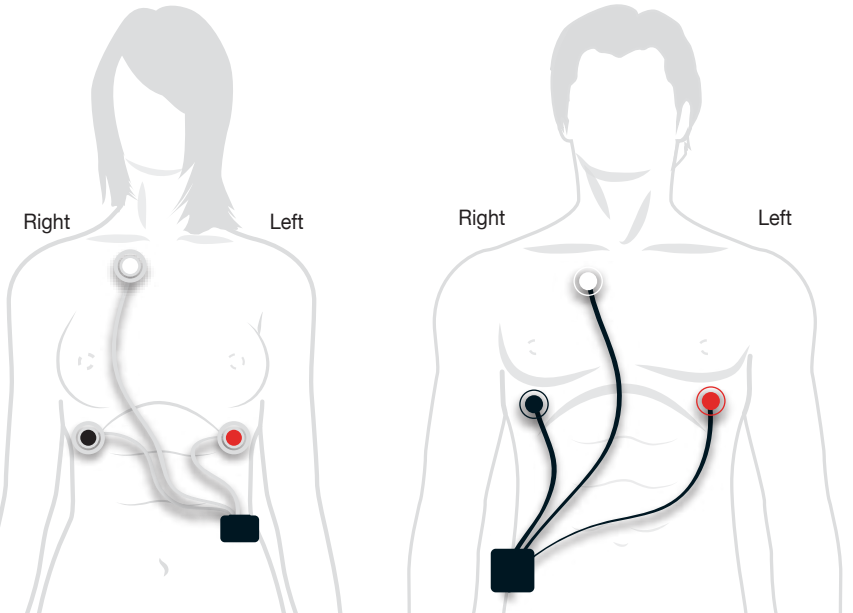

2 Applying the Electrode Patches

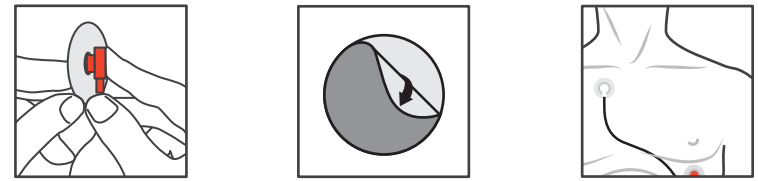

Snap Electrodes Peel backing Adhere to chest

One by one, peel each electrode from the backing and apply it to the chest, using the placement in the illustrations and being mindful of where the white, red and black electrodes should be placed.

tip Remember, "White on Right" when applying electrodes. This will help you remember to always place the *white* electrode on the upper *right* side of your chest.

tip Change the electrode patches every two days. When re-applied, change their location slightly to prevent skin irritation.

tip Keep the Pendant and Smartphone in close proximity to each other as much as possible during your procedure, so data transfer can occur.

3 Starting the Pendant



Insert a fresh battery into the Pendant. Pendant batteries need to be changed about every 1½ to 2 days.

tip Whenever changing the battery, always turn the pendant off first by pressing and holding the On/Off button until you hear three solid tones.

Press and hold the **On/Off** button on the side of the Pendant until you see the device lights blink and hear a three-tone chirp.

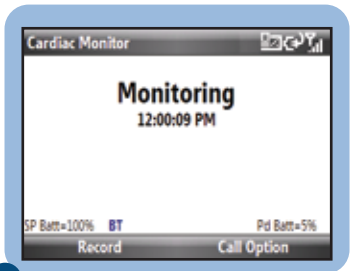
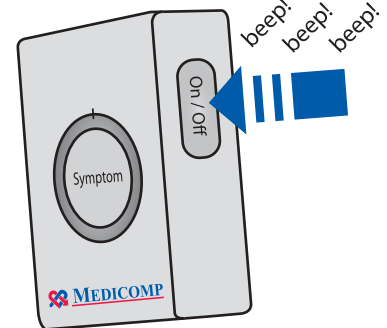

tip Pendant (Pd) and Smartphone (SP) battery percentages are found on the display screen of the Smartphone.

4 Starting the Smartphone



Turn on the Smartphone by pressing and releasing the **POWER** button located on the upper-left side.

Wait for the Smartphone to run through its initialization process until the main screen appears.

Press the **Left Soft Key** on the Smartphone under *Start Procedure*.

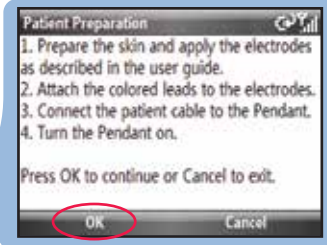

Press the **Left Soft Key** under *OK*.

Press the **Left Soft Key** under *Accept Settings* to continue.
If you have a pacemaker, or are connecting a child, please call us at 877-996-5553.

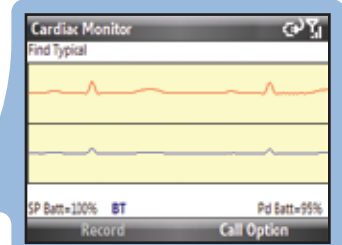
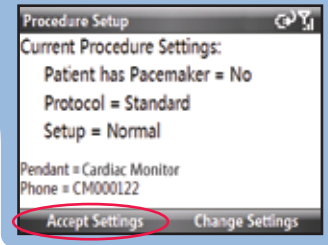

A busy indicator may appear while the Smartphone finishes initializing and acquires your ECG signal.

When the Smartphone has recognized your ECG, the ECG waveform will disappear and the screen will display *Monitoring*.

Your cardiac monitoring procedure is now running.

